

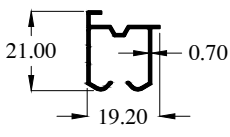

CURTAIN RAIL (CR SERIES)

NO.	PROFILE NO.	WEIGHT (kg / m)	AP (mm)	LENGTH (m , ft)	DESCRIPTIONS	REMARKS
1	CR1003	0.144	145.00			
2	CR1007	0.116	119.91			
3	CR1011	0.170	147.14			
4	CR1011-1	0.198	145.40			
5	CR1199	0.100	109.96			
6	CR2005	0.124	76.37			
7	CR4900	0.429	197.12			

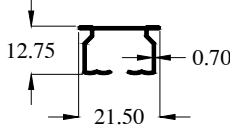
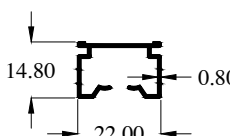
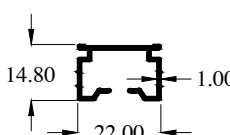
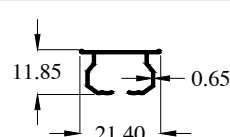
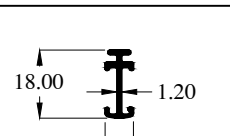
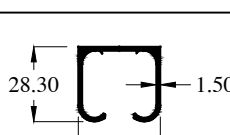

CURTAIN RAIL
(SG SERIES)

NO.	PROFILE NO.	WEIGHT (kg / m)	AP (mm)	LENGTH (m , ft)		DESCRIPTIONS	REMARKS
8	SG1084-1	0.169	78.57				
9	SG1085-1	0.142	69.80				
10	SG1087	0.175	133.88				
11	SG1093	0.238	185.41				
12	SG1094	0.119	81.43				
13	SG1103-B	1.399	293.29				
14	SG1109	0.510	151.10				
15	SG1112	0.215	159.09				
16	SG1113-1	0.378	192.42				
17	SG1117	0.252	184.04				

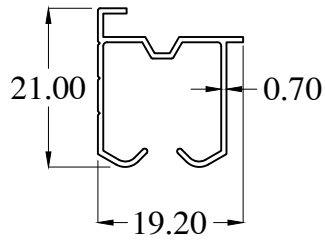

CR1003
WT : 0.144 Kg/m

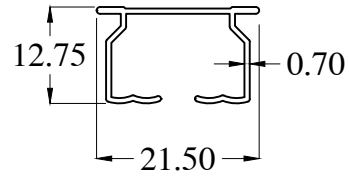

CR1007
WT : 0.116 Kg/m

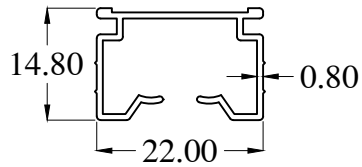

CR1011
WT : 0.170 Kg/m

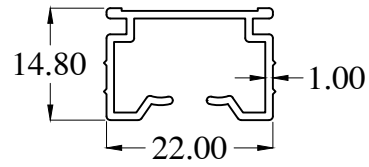

CR1011-1
WT : 0.198 Kg/m

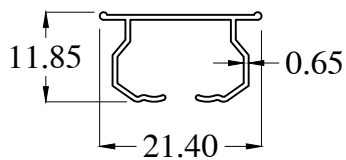

CR1199
WT : 0.100 Kg/m

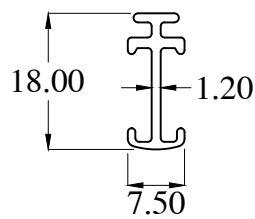

CR2005
WT : 0.124 Kg/m

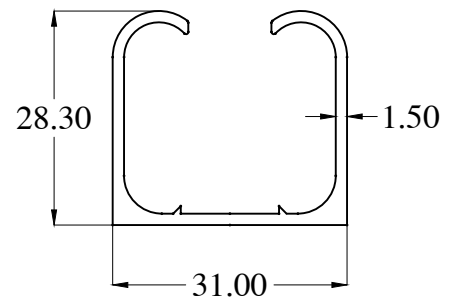

CR4900
WT : 0.429Kg/m

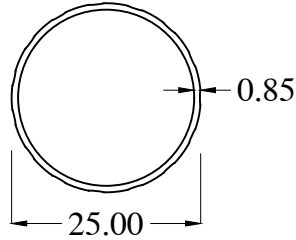

SG1084-1
WT : 0.169 Kg/m

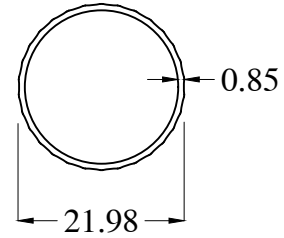

SG1085-1
WT : 0.142 Kg/m

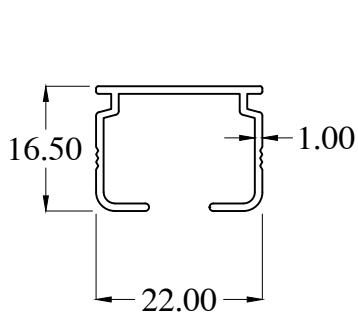

SG1087
WT : 0.175 Kg/m

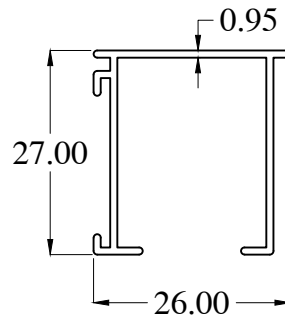

SG1093
WT : 0.238 Kg/m

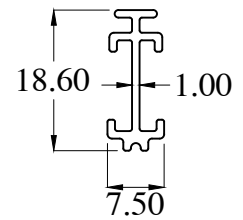

SG1094
WT : 0.119 Kg/m

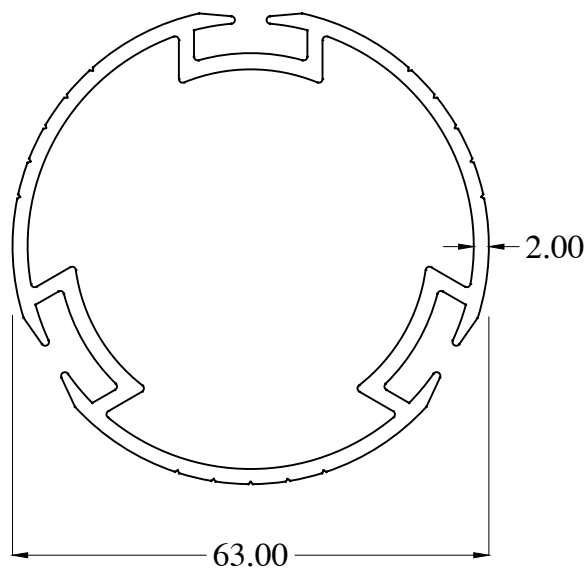

SG1103-B
WT : 1.399 Kg/m

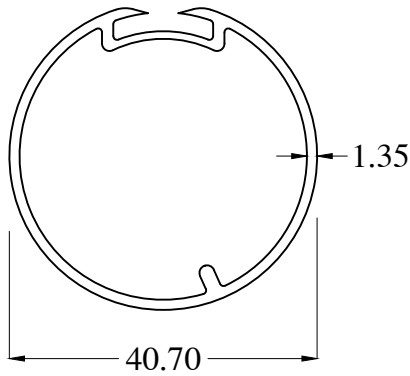

SG1109
WT : 0.510 Kg/m

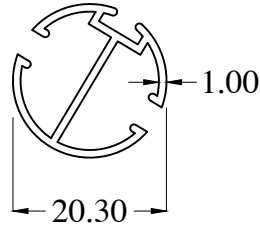

SG1112
WT : 0.215 Kg/m

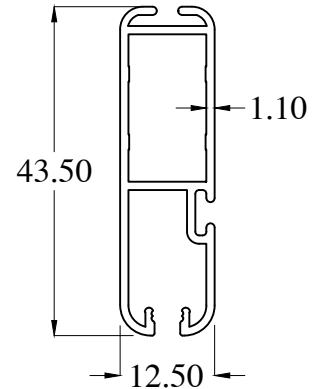

SG1113-1
WT : 0.378 Kg/m

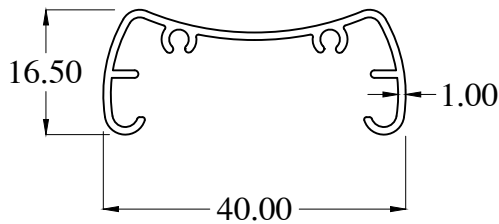

SG1117
WT : 0.252 Kg/m

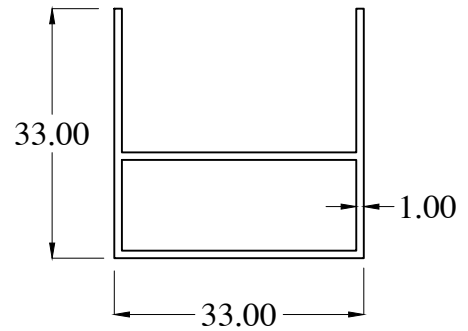

SG1118
WT : 0.347 Kg/m

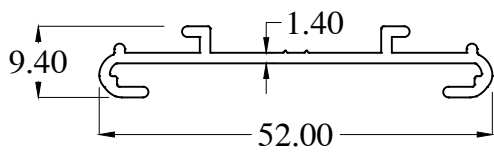

SG1243
WT : 0.307 Kg/m

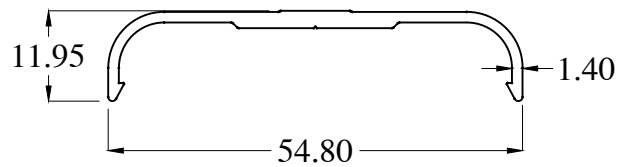

SG1244
WT : 0.313 Kg/m

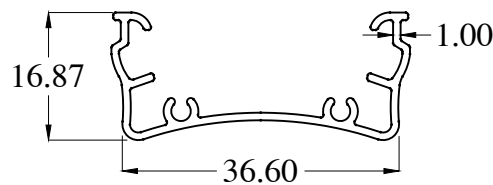

SG1252
WT : 0.267 Kg/m